

**Norway's most  
central and  
sustainable location  
for congresses,  
meetings and  
banquets**

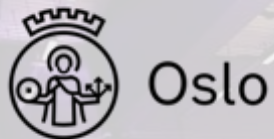

**NOVA  
SPEKTRUM**



## Efficient and available

NOVA Studios can offer refurbished meeting-, congress- and banquet venues with a prime location between Oslo city centre and Oslo International Airport, a 10-minute train ride in each direction. Our venue offers the best option when gathering people in a sustainable way. We cater to every need with various & flexible options and up to-date technical solutions as standard. We are proud of our unique in-house food experiences.

NOVA Spektrum represent more than 100 years of experience, creating memorable and successful events of every kind, accommodating events regardless of size and requirements. We look forward to assisting throughout the planning process and execution.

# Arrival and entrance

Entrance west

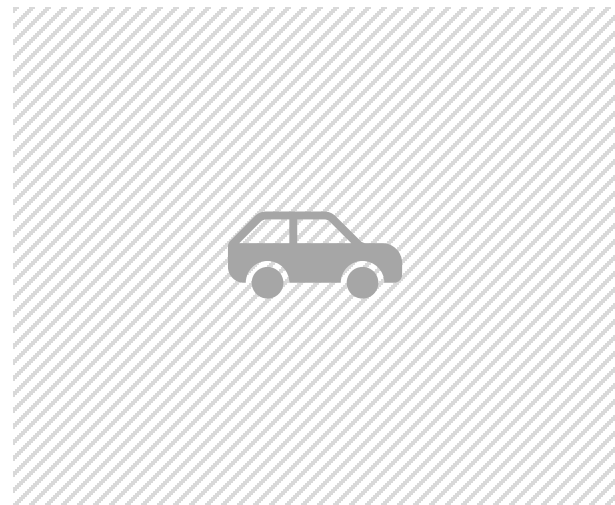

NOVA SPEKTRUM

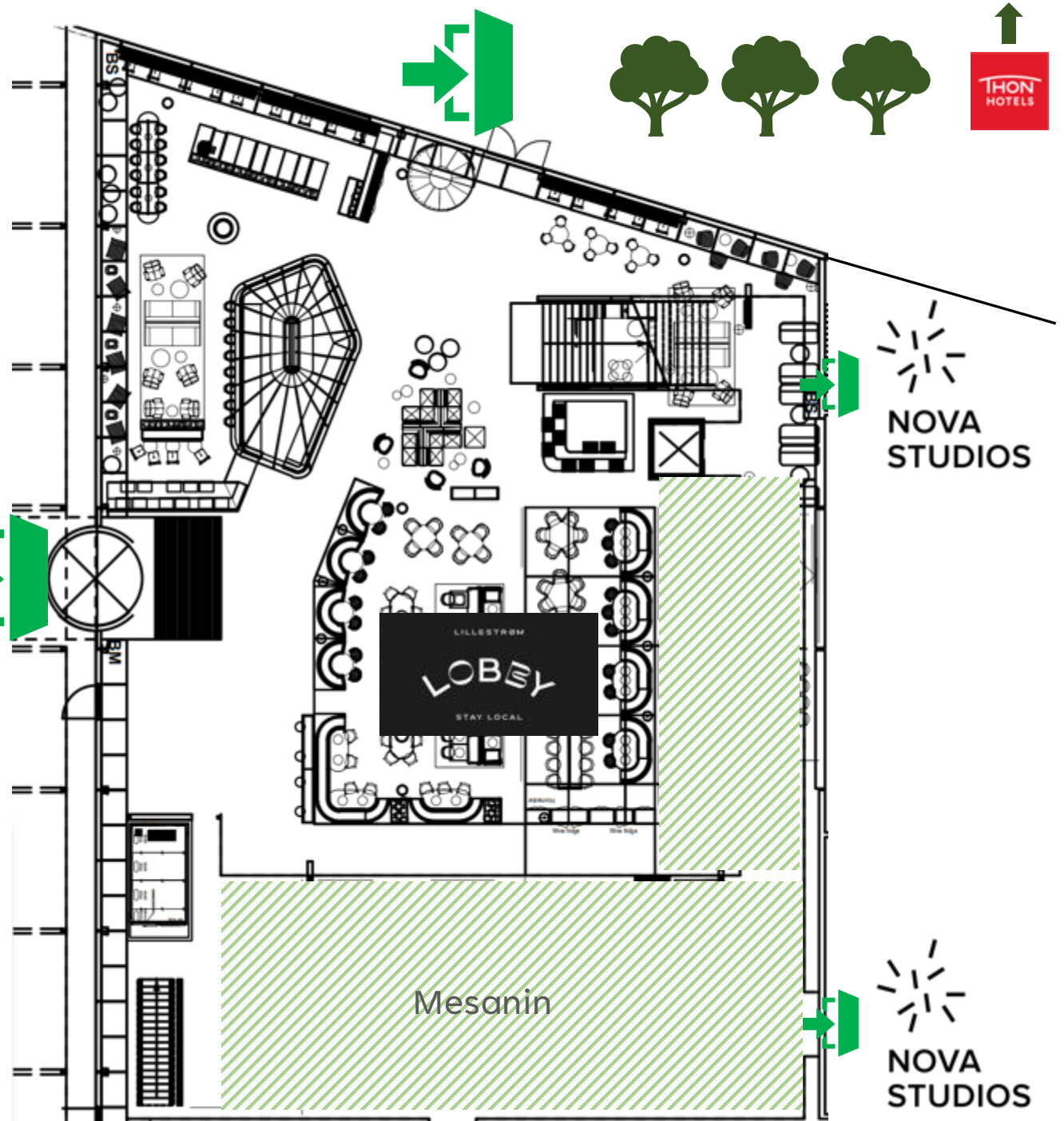



# NOVA STUDIOS

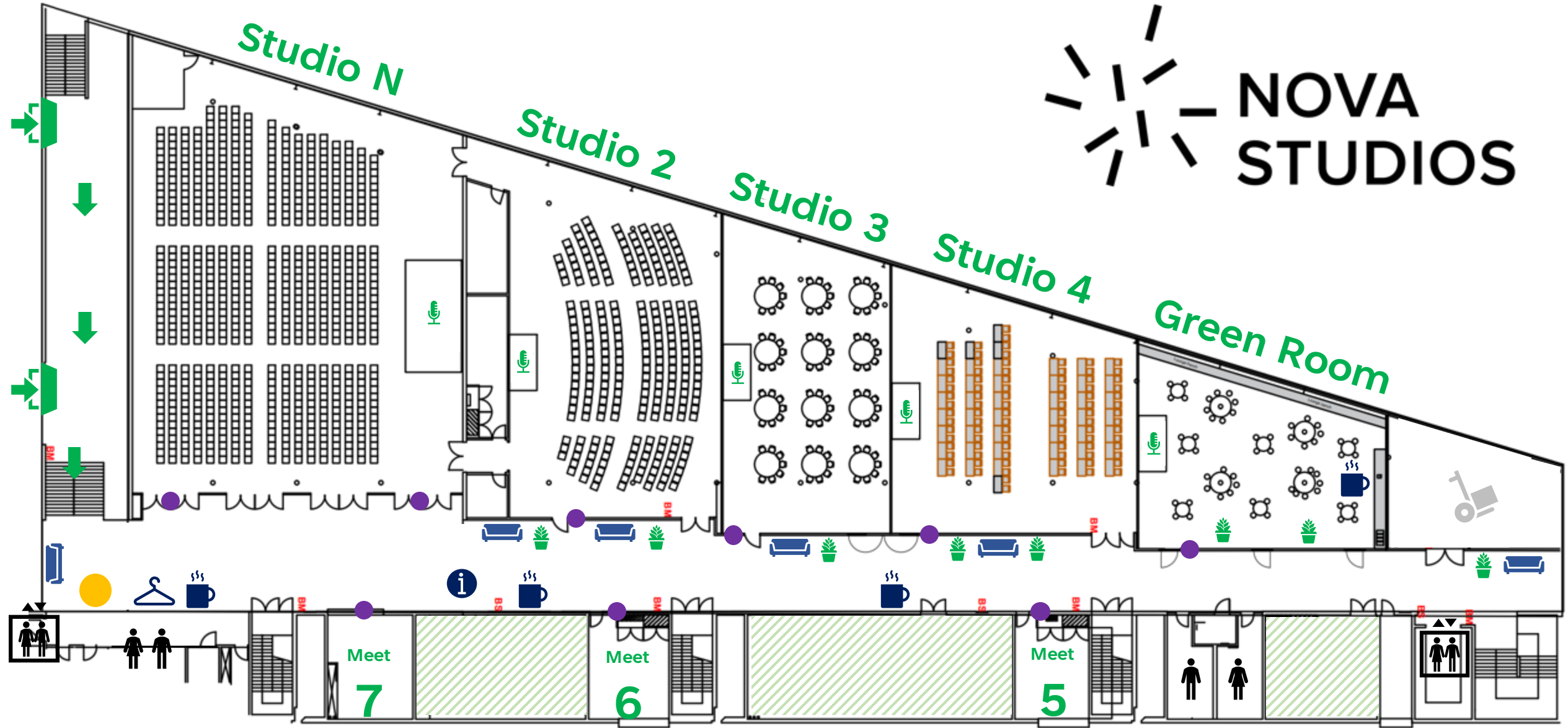

Wayfinder  Information screens 

# Standard technical equipment

## Studio N

Laser projector  
 Projector screen  
 (16:9)  
 Sound system  
 2 hand held mic.  
 4 head worn mic.  
 6 LED front lights  
 Touch panel\*  
 Interactive loop  
 WIFI  
 Made ready for  
 added technical  
 equipment  
 \*Wall mounted &  
 panel for optional  
 placement

## Studio 2

Laser projector  
 Projector screen  
 (16:9)  
 Sound system  
 2 hand held mic.  
 2 head worn mic.  
 4 LED front lights  
 Touch panel\*  
 Interactive loop  
 WIFI  
 Made ready for  
 added technical  
 equipment  
 \*Wall mounted &  
 panel for optional  
 placement

## Studio 3

Laser projector  
 Projector screen  
 (16:9)  
 Sound system  
 2 hand held mic.  
 2 head worn mic.  
 4 LED front lights  
 Touch panel\*  
 Interactive loop  
 WIFI  
 Made ready for  
 added technical  
 equipment  
 \*Wall mounted &  
 panel for optional  
 placement

## Studio 4

Laser projector  
 Projector screen  
 (16:9)  
 Sound system  
 2 hand held mic.  
 2 head worn mic.  
 2 LED front lights  
 Touch panel\*  
 Interactive loop  
 WIFI  
 Made ready for  
 added technical  
 equipment  
 \*Wall mounted &  
 panel for optional  
 placement

## Green Room

Laser projector  
 Projector screen  
 Sound system  
 1 hand held mic.  
 2 head worn mic.  
 2 LED front lights  
 Touch panel  
 Interactive loop  
 WIFI  
 Made ready for  
 added technical  
 equipment

7

6

5

Wayfinder ●

Information screens ●



# We serve coffee from Norway's best coffee roaster!



Our provider, Romerike Coffee Roastery, was named the Norwegian champion in coffee roasting in 2023.



A collage of food images. The top left shows a sandwich with green vegetables. The top right shows a tray of colorful macarons. The bottom left shows a yogurt parfait with raspberries and granola. The bottom right shows a sandwich with meat and vegetables. A semi-transparent white box with text is overlaid in the center.

# **A great food experience**

At NOVA Sepektrum you can expect a carefully considered food experience with genuine and honest food throughout the day, with high quality in ingredients & preparation, and local manufacturers are paramount.

# Capacity

|                     | Classroom | Theatre | Round tables<br>8 per table | Round tables<br>10 per table* | M2  |
|---------------------|-----------|---------|-----------------------------|-------------------------------|-----|
| <b>Studio N</b>     | 390       | 710     | 240                         | 300                           | 620 |
| <b>Studio 2</b>     | 180       | 300     | 120                         | 150                           | 360 |
| <b>Studio 3</b>     | 120       | 190     | 94                          | 120                           | 242 |
| <b>Studio 4</b>     | 120       | 230     | 120                         | 150                           | 290 |
| <b>Studio 2+3</b>   | 320       | 600     | 230                         | 280                           | 602 |
| <b>Studio 3+4</b>   | 250       | 470     | 200                         | 250                           | 532 |
| <b>Studio 2+3+4</b> | 500       | 900     | 280                         | 330                           | 892 |

\*for banquets

### Standard technical equipment

Laser projector  
Projector screen (16:9)  
Sound system  
2 handheld microphones  
4 headworn microphones  
6 LED front lights  
Touch panel\*  
Interactive loop  
WIFI  
Made ready for added technical equipment  
\*Wall mounted & panel for optional placement

### Capacity

|                    |             |
|--------------------|-------------|
| Size               | 620 m2      |
| Class room style   | 390 persons |
| Theatre            | 710 persons |
| Round tables (8)   | 240 persons |
| Round tables (10)* | 300 persons |

\* For banquets

### Other information

Universal design  
Balanced ventilation

# Studio N

### Standard technical equipment

Laser projector  
Projector screen (16:9)  
Sound system  
2 handheld microphones  
2 headworn microphones  
4 LED front lights  
Touch panel\*  
Interactive loop  
WIFI  
Made ready for added technical equipment  
\*Wall mounted & panel for optional placement

### Capacity

|                    |             |
|--------------------|-------------|
| Size               | 360 m2      |
| Class room style   | 180 persons |
| Theatre            | 200 persons |
| Round tables (8)   | 120 persons |
| Round tables (10)* | 150 persons |

\* For banquets

### Other information

Universal design  
Balanced ventilation

# Studio 2

## Standard technical equipment

Laser projector  
Projector screen (16:9)  
Sound system  
2 handheld microphones  
2 headworn microphones  
4 LED front lights  
Touch panel\*  
Interactive loop  
WIFI  
Made ready for added technical equipment  
\*Wall mounted & panel for optional placement

## Capacity

|                    |             |
|--------------------|-------------|
| Size               | 242 m2      |
| Class room style   | 120 persons |
| Theatre            | 190 persons |
| Round tables (8)   | 94 persons  |
| Round tables (10)* | 120 persons |
| * For banquets     |             |

## Other information

Universal design  
Balanced ventilation

# Studio 3

## Standard technical equipment

Laser projector  
Projector screen (16:9)  
Sound system  
2 handheld microphones  
2 headworn microphones  
2 LED front lights  
Touch panel\*  
Interactive loop  
WIFI  
Made ready for added technical equipment  
\*Wall mounted & panel for optional placement

## Capacity

|                    |             |
|--------------------|-------------|
| Size               | 290 m2      |
| Class room style   | 120 persons |
| Theatre            | 230 persons |
| Round tables (8)   | 120 persons |
| Round tables (10)* | 150 persons |

\* For banquets

## Other information

Universal design  
Balanced ventilation

# Studio 4

### Standard technical equipment

- Laser projector
- Projector screen
- Sound system
- 1 handheld microphones
- 2 headworn microphones
- 2 LED front lights
- Touch panel
- Interactive loop
- WIFI

### Capacity

|                  |             |
|------------------|-------------|
| Size             | 220 m2      |
| Capacity         | 200 persons |
| Class room style | 120 persons |
| Theatre          | 230 persons |
| Round tables (8) | 120 persons |

### Other information

- Universal design
- Balanced ventilation
- Coffee machine

# Green Room



|               | Class room | Theatre | Board room | U-shape | M2 |
|---------------|------------|---------|------------|---------|----|
| <b>Meet 5</b> | 12         | 20      | 10         | 8       | 35 |
| <b>Meet 6</b> | 16         | 20      | 10         | 12      | 40 |
| <b>Meet 7</b> | 20         | 30      | 14         | 4       | 43 |

Standard technical equipment:  
Screen with HDMI connection and WIFI

The image shows the interior of the Lillestrøm Lobby restaurant. The space is filled with round and rectangular tables, some with yellow upholstered chairs and others with wooden chairs. A large, leafy tree in a planter sits on a long wooden table in the foreground. The background features a curved, red-upholstered booth with several round tables set for dining. The lighting is warm and ambient, with small lamps on the tables. A semi-transparent white box with text is overlaid on the right side of the image.

# Lillestrøm Lobby

Welcome to Lillestrøm Lobby, our informal yet classic restaurant, adjacent to NOVA Studios. With a capacity for 130 people we can serve a various of options. Alternatively our mezzanine can also be utilized, providing extra capacity. Furthermore Lillestrøm Lobby serves as an excellent venue for all types of events. With spacious areas, flexible solutions, and flavorful dishes, we take pride in high-quality ingredients and preparation.

LILLESTRØM

LOBBY

STAY LOCAL



# Contact information

[novastudios.no](http://novastudios.no)

[studios@novaspektrum.no](mailto:studios@novaspektrum.no)

[Location](#)